



evolution

MASONRY SCREWS

**MASONRY
SCREWS WITH
MUSCLE!**

COUNTERSUNK HEAD

SELF TAPPING MASONRY SCREW

TOUGH ON CONCRETE



MSCSK Self Tapping Masonry 4.8mm (3/16")

CODE	SIZE	WASHER	BOX
MSCSK4.8-32-2	4.8 x 32	NO	100
MSCSK4.8-45-2	4.8 x 45	NO	100
MSCSK4.8-57-2	4.8 x 57	NO	100
MSCSK4.8-70-2	4.8 x 70	NO	100
MSCSK4.8-82-2	4.8 x 82	NO	100
MSCSK4.8-100-2	4.8 x 100	NO	100



EvoShield® Ceramic Coated Countersunk-Head for Concrete and Masonry

General purpose fastener for fixing timbers (battens, trunks, etc), board materials (cement board, plywood, OSB, etc) and general components to concrete, masonry, brick or blockwork substrates.

- 1** Nail point ensures self-alignment in pilot hole and fixing accuracy. This product requires a 4.35mm pilot hole. **SEE PAGE 7**
- 2** Non-expansion fastener type makes this product ideal for fixing close to substrate edges.
- 3** Aggressive 60° thread angle and hi-lo proprietary thread form ensures maximum thread engagement.
- 4** SAE C1018 carbon steel (hardened >55 HRC) construction provides exceptional mechanical performance.
- 5** 90° Countersunk head (with Phillips No. 2 female recess) allows for rapid and stable installation.

EvoShield® Ceramic Coated Countersunk-Head for Concrete and Masonry

- 6** EvoShield® coating provides superior corrosion protection over traditional galvanised and sherardised methods.
- 7** 90° Countersunk head (with Phillips No. 3 female recess) allows for rapid and stable installation.
- 8** Increased core-diameter SAE C1018 carbon steel construction provides significantly increased tensile and shearing resistances over smaller 4.8mm diameter products.

MSCSK Self Tapping Masonry 6.3mm (1/4")

CODE	SIZE	WASHER	BOX
MSCSK6.3-32-3	6.3 x 32	NO	100
MSCSK6.3-45-3	6.3 x 45	NO	100
MSCSK6.3-57-3	6.3 x 57	NO	100
MSCSK6.3-70-3	6.3 x 70	NO	100
MSCSK6.3-82-3	6.3 x 82	NO	100
MSCSK6.3-100-3	6.3 x 100	NO	100
MSCSK6.3-125-3	6.3 x 125	NO	100
MSCSK6.3-150-3	6.3 x 150	NO	100



CALL TO PLACE ORDER

T: +44 (0)141 647 7100

E: sales@evolutionfasteners.co.uk

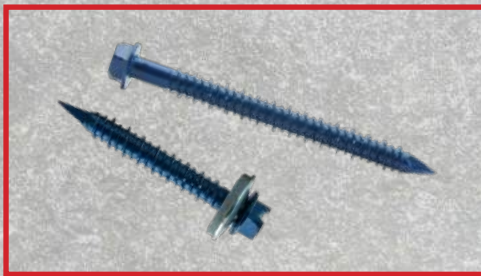

SLOTTED HEAD

SELF TAPPING MASONRY SCREW

TOUGH ON CONCRETE

EvoShield® Ceramic Coated Hexagonal-Head for Concrete and Masonry (without Washer)

General purpose fastener for fixing timbers (battens, trunking, etc), board materials (cement board, plywood, OSB, etc), structural framing or partitioning sections (deflection head, track, etc) and general components to concrete, masonry, brick or blockwork substrates.

- 1** Nail point ensures self-alignment in pilot hole and fixing accuracy. This product requires a 5.15mm pilot hole. **SEE PAGE 7**
- 2** Non-expansion fastener type makes this product ideal for fixing close to substrate edges.
- 3** Aggressive 60° thread angle and hi-lo proprietary thread form ensures maximum thread engagement .
- 4** SAE C1018 carbon steel (hardened >55 HRC) construction provides exceptional mechanical performance .
- 5** 5/16" (8.0mm AF) hexagonal (male) socket head allows rapid installation using standard non-impacting screwdrivers and non-impact drive bits. The slot allows tightening and loosening of the fasteners by hand using a standard flat screwdriver.
- 6** EvoShield® coating provides superior corrosion protection over traditional galvanised and sherardised methods.

EvoShield® Ceramic Coated Hexagonal-Head for Concrete and Masonry (with Washer)

General purpose fastener for fixing timbers (battens, trunking, etc), board materials (cement board, plywood, OSB, etc), structural framing or partitioning sections (deflection head, track, etc) and general components to concrete, masonry, brick or blockwork substrates. This variant is suitable where mitigation against water ingress is required.

- 7** Integrated 16mm ØD weather sealing washer constructed of a 3.0mm EPDM gasket bonded to a galvanised steel compression plate.

SEE PAGE 7

CALL TO PLACE ORDER

T: +44 (0)141 647 7100

E: sales@evolutionfasteners.co.uk

MSHH

Self Tapping Masonry (w/o Washer)
6.3mm (1/4")

CODE	SIZE	WASHER	BOX
MSHH6.3-32-516	6.3 x 32.0 mm	NO	100
MSHH6.3-45-516	6.3 x 45.0 mm	NO	100
MSHH6.3-57-516	6.3 x 57.0 mm	NO	100
MSHH6.3-70-516	6.3 x 70.0 mm	NO	100
MSHH6.3-82-516	6.3 x 82.0 mm	NO	100
MSHH6.3-100-516	6.3 x 100.0 mm	NO	100
MSHH6.3-125-516	6.3 x 125.0 mm	NO	100
MSHH6.3-140-516	6.3 x 140.0 mm	NO	100
MSHH6.3-160-516	6.3 x 160.0 mm	NO	100
MSHH6.3-180-516	6.3 x 180.0 mm	NO	50
MSHH6.3-200-516	6.3 x 200.0 mm	NO	50
MSHH6.3-254-516	6.3 x 254.0 mm	NO	50

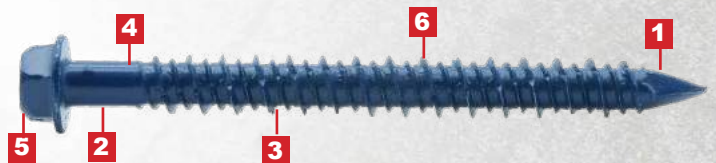

MSHHW

Self-Tapping Masonry (w/ Washer)
6.3mm (1/4")

CODE	SIZE	WASHER	BOX
MSHHW6.3-32-516	6.3 x 32.0 mm	YES	100
MSHHW6.3-45-516	6.3 x 45.0 mm	YES	100
MSHHW6.3-57-516	6.3 x 57.0 mm	YES	100

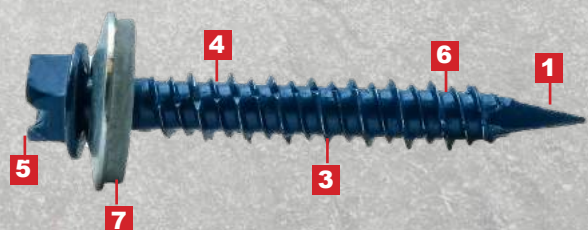

A4 STAINLESS STEEL COUNTERSUNK HEAD

BI-METAL™ SELF-TAPPING MASONRY SCREWS

MAXIMUM HOLDING POWER

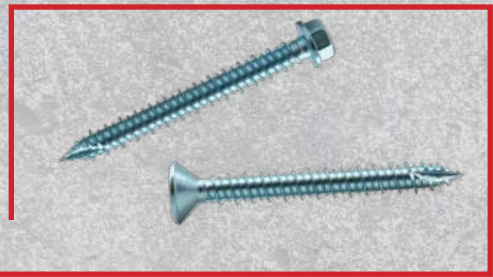

A4CSK

**Self-Tapping Masonry
(A4 Stainless Steel)**

6.3mm (1/4")

CODE	SIZE	WASHER	BOX
A4CSK6.3-45-GP	6.3mm x 45mm	NO	100
A4CSK6.3-57-GP	6.3mm x 57mm	NO	100
A4CSK6.3-75-GP	6.3mm x 75mm	NO	100

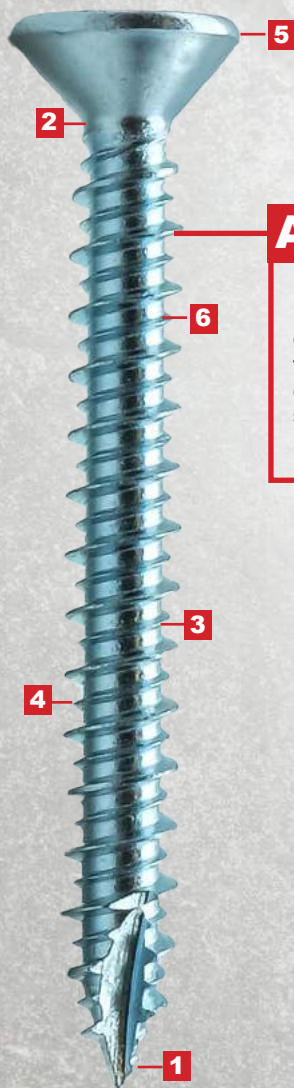

A4 BI-METAL

Bi-Metal™ stainless steel construction makes these ideal for mitigation against bi-metallic corrosion in aluminium or copper/ tin substrates.

Bi-Metal™ (A4 Stainless Steel) Countersunk-Head for Concrete and Masonry

General purpose fastener for fixing timbers (battens, trunking, etc), board materials (cement board, plywood, OSB, etc) and general components to concrete, masonry, brick or blockwork substrates in aggressive environments.

- 1** Type 17 point ensures self-alignment in pilot hole and fixing accuracy as well as limited capability for embedment in timber or steel ($\leq 1.2\text{mm}$ total thickness) substrates. This product requires a 5.15mm pilot hole.
- 2** Non-expansion fastener type makes this product ideal for fixing close to substrate edges.
- 3** Aggressive 60° thread angle and hi-lo proprietary thread form ensures maximum thread engagement is achieved in concrete and masonry substrates.
- 4** Bi-Metal™ construction synergises the self-drilling performance of a SAE C1018 carbon steel self-drilling point with the exceptional corrosion resistance of an AISI 316 austenitic stainless steel body and head.
- 5** 90° Countersunk head (with Phillips No. 3 female recess) allows for rapid and stable installation using standard non-impacting screwdrivers and non-impact drive bits.
- 6** A4-50 (EN 1.4401 / AISI 316) stainless steel body and head provide ultimate corrosion protection that exceeds organic coating performance. This allows this product to be used in environments with a corrosivity category of up to C4.

CALL TO PLACE ORDER

T: +44 (0)141 647 7100

E: sales@evolutionfasteners.co.uk

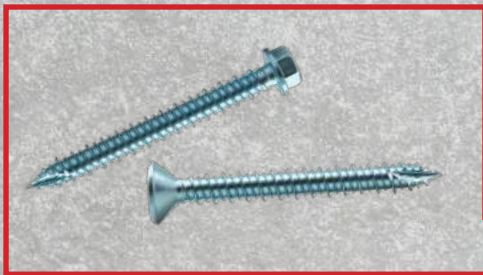

A4 STAINLESS STEEL HEXAGONAL HEAD

BI-METAL™ SELF-TAPPING MASONRY SCREWS

MAXIMUM HOLDING POWER

Bi-Metal™ (A4 Stainless Steel) Hexagonal-Head for Concrete and Masonry

General purpose fastener for fixing timbers (battens, trunking, etc), board materials (cement board, plywood, OSB, etc), structural framing or partitioning sections (deflection head, track, etc) and general components to concrete, masonry, brick or blockwork substrates in aggressive environments.

A4HH

Self-Tapping Masonry (A4 Stainless Steel)

6.3mm (1/4")

CODE	SIZE	WASHER	BOX
A4HH6.3-32-GP	6.3mm x 32mm	NO	100
A4HH6.3-45-GP	6.3mm x 45mm	NO	100
A4HH6.3-57-GP	6.3mm x 57mm	NO	100
A4HH6.3-70-GP	6.3mm x 70mm	NO	100
A4HH6.3-82-GP	6.3mm x 82mm	NO	100
A4HH6.3-100-GP	6.3mm x 100mm	NO	100
A4HH6.3-125-GP	6.3mm x 125mm	NO	100
A4HH6.3-140-GP	6.3mm x 140mm	NO	100

1 Type 17 point ensures self-alignment in pilot hole and fixing accuracy as well as limited capability for embedment in timber or steel ($\leq 1.2\text{mm}$ total thickness) substrates. This product requires a 5.15mm pilot hole.

2 Non-expansion fastener type makes this product ideal for fixing close to substrate edges.

3 Aggressive 60° thread angle and hi-lo proprietary thread form.

4 Bi-Metal™ construction synergises the self-drilling performance of a SAE C1018 carbon steel self-drilling point

5 5/16" (8.0mm AF) hexagonal (male) socket head allows rapid installation using standard non-impacting screwdrivers and non-impact drive bits.

6 A4-50 (EN 1.4401 / AISI 316) stainless steel body and head provide ultimate corrosion protection that exceeds organic coating performance.

7 Integrated 16mm ØD weather sealing washer constructed of a 3.0mm EPDM gasket bonded to an A4 stainless steel compression plate are available separately (see below).

SEE PAGE 7

A4 BI-METAL

Bi-Metal™ stainless steel construction makes these ideal for mitigation against bi-metallic corrosion in aluminium or copper/ tin substrates.

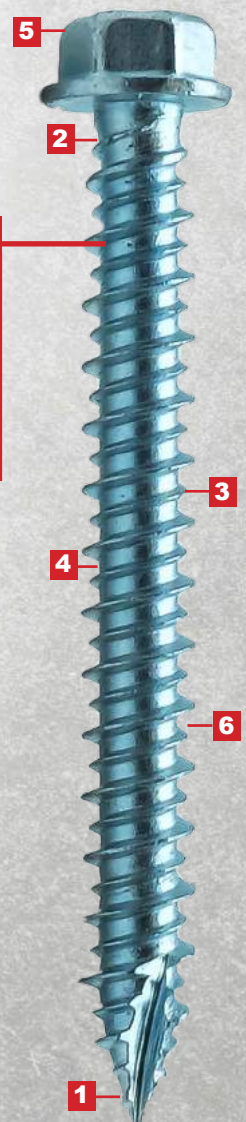

CALL TO PLACE ORDER

T: +44 (0)141 647 7100

E: sales@evolutionfasteners.co.uk

HEAVY DUTY, MULTI-PURPOSE ROOFING SCREW

LONG LENGTH

ERS Self-Tapping Roofing Screw 6.3mm (1/4")

CODE	SIZE	WASHER	BOX
ERS76	76 mm	NO	100
ERS100	100 mm	NO	100
ERS127	127 mm	NO	100
ERS152	152 mm	NO	100
ERS176	176 mm	NO	50
ERS200	200 mm	NO	50
ERS225	225 mm	NO	50
ERS250	250 mm	NO	50



CALL TO PLACE ORDER

T: +44 (0)141 647 7100

E: sales@evolutionfasteners.co.uk



EvoShield® Ceramic Coated Domed-Head Roofing Screws for Concrete and Masonry

General purpose roofing fastener for fixing insulation, single-ply membranes and soffit boards to steel ($\leq 1.2\text{mm}$), timber and concrete substrates.

- 1** **Spoon point** ensures self-alignment in pilot hole and fixing accuracy. This product requires a 5.15mm pilot hole.
- 2** Non-expansion fastener type makes this product **ideal for fixing close to substrate edges**.
- 3** **Aggressive 60° thread angle** coarse thread form ensures maximum thread engagement is achieved in concrete and masonry substrates.
- 4** SAE C1018 carbon steel hardened >55 HRC) construction **provides exceptional mechanical performance** including tensile and shear resistances. Increased core-diameter SAE C1018 carbon steel construction provides significantly increased tensile and shearing resistances over smaller 4.8mm diameter products.
- 5** **Large-diameter domed head** (with Torx 30 female recess) allows rapid installation using standard non-impacting screwdrivers and non-impact drive bits and provides for exceptional pull-over resistance of fixture materials.
- 6** **EvoShield® coating** provides superior **corrosion protection** over traditional galvanised and sherardised methods and ensures long-term survivability in C1, C2 and C3 corrosivity category environments.
- 7** **Various stress plates** are available (see right) for increased application versatility across a wide range of fixture materials.

SEE PAGE 7



ACCESSORIES

CALL TO PLACE ORDER

T: +44 (0)141 647 7100

E: sales@evolutionfasteners.co.uk

Evolution®

SDS Plus Drill Bit

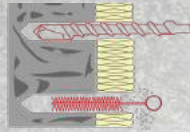

CODE	SIZE	FOR SCREW DIA
SDS435180	4.35 x 180mm	4.80mm (3/16")
SDS515180	5.15 x 180mm	6.30mm (1/4")
SDS515205	5.15 x 205mm	6.30mm (1/4")
SDS515290	5.15 x 290mm	6.30mm (1/4")
SDS515310	5.15 x 310mm	6.30mm (1/4")



General purpose drill bit designed to fit all SDS Plus chucks and collets. This product is especially suited for the rapid drilling of pilot holes for **Evolution® concrete and masonry screws**. Pilot holes should always be cleaned out in accordance with product installation procedures.

- 1 High quality, twin-fluted drilling point with brazed carbide tips ensure rapid drilling performance in concrete, brick, block and stone substrates.
- 2 Hex-shank allows attachment of various fastener installation systems such as (but not limited to) the Evolution® ED1000 drive kit.
- 3 Product will work with any power tool that utilises an SDS Plus chuck or collet system.

Stress Plates

CODE	SIZE	BOX
SPR70	70mm	100
SPR90	90mm	100
SP082	Oval 82x40mm	100



Spreading the loading when fixing membrane, insulation and single-ply materials in roofing applications helps mitigate against the fixture material being pulled over the head of the fasteners. This product is required when fasteners or the fixture will be subjected to wind loads, etc.

Washers

CODE	SIZE	BOX
BW16	16x3mm	1,000
BW19	19x3mm	1,000



Integrated 16mm ØD weather sealing washer constructed of a 3.0mm EPDM gasket bonded to a galvanised steel compression plate.

A4 Stainless Washers

CODE	SIZE	BOX
SS12	12x3mm	100
SS16	16x3mm	100



AISI 316 (A4-50/ EN 1.4401) stainless steel washers for use in conjunction with Evolution® screws.

Non-Magnetic Hex-Nut Driver

CODE	SIZE	BOX
SES5/16	5/16"x45mm	1

Non-magnetic hex-nut driver does not draw swarf and debris inside female socket cavity.

Sprung-clip and ball detent securely grips and drives fastener heads.



Magnetic Nut Setter

CODE	SIZE	BOX
MS5/16	5/16"x45mm	1
MES5/16	5/16"x65mm	1



Professional nut driver, used to drive 5/16" hexagonal headed screws, bolts and nuts.

Integral magnet to hold fastener in-position and reduce wobble on installation.



QUALITY ASSURANCE AND LABORATORY TESTING

The Evolution® Gold Standard™ is continuously maintained through rigorous batch testing in our UKAS accredited testing laboratory which utilises state-of-the-art equipment and is staffed with a team of Structural, Civil, Mechanical and Chemical Engineers.



For more information on our extensive testing capabilities or if you wish to receive free training and Continued Professional Development, please e-mail

technical@evolutionfasteners.co.uk

AVAILABLE FOR DOWNLOAD ON
OUR WEBSITE:

www.evolutionfasteners.co.uk



2020* BOARD FIXING GUIDE
AND
2021* INSULATION FIXINGS GUIDE
AVAILABLE ONLINE
FOR DOWNLOAD



2020* PRODUCT GUIDE

AND OUR

2020* BI-METAL AND STAINLESS STEEL GUIDE

ALSO AVAILABLE ONLINE FOR DOWNLOAD